



SPICER[®]
Torque-Hub[™]

Spicer Torque-Hub[™]

CTL Series Track Drive



Spicer Torque-Hub[™] CTL Series
specifically designed for today's
high-performance hydraulically
driven Compact Track Loader

CTL Series

Spicer Torque-Hub™ CTL Series Track Drive

The CTL Series from Dana comprises 4 sizes featuring integrated hydraulic motors uniquely suited for tracked equipment. A robust design, with thousands in daily operation and proven under the most demanding conditions, the CTL Series is popular with leading OEMs building Compact Track Loaders.

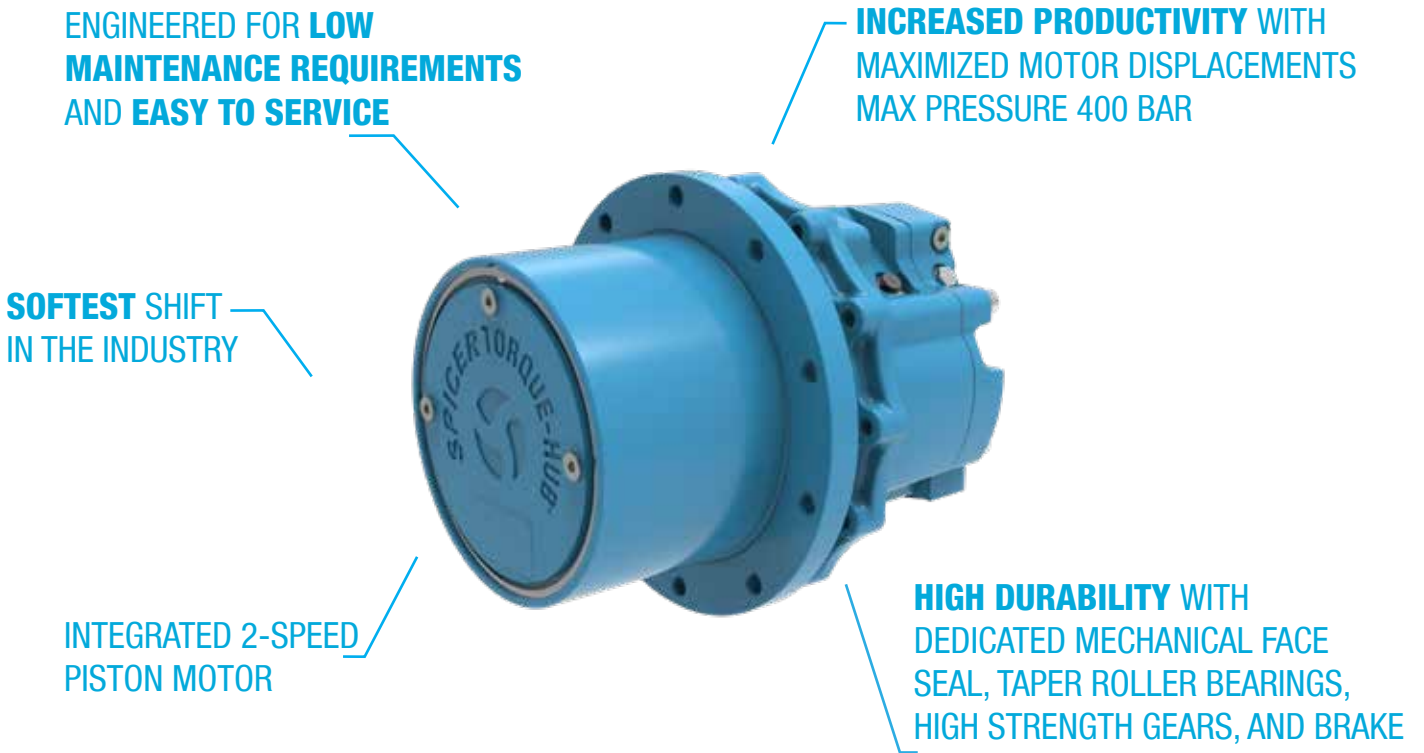

Additional Features and Benefits

- 1 Product range specifically designed for modern high-efficiency Compact Track Loaders
- Torque Ratings from 5,000 to 17,000 Nm
- Higher travel speed
- 2 speed design enhancing vehicle performances
- Mechanical face seal for reliable protection, hub and spindle designed for severe environmental conditions
- Enhanced start up torque in a compact package size and integrated design
- High radial load capacity bearings and robust internal brake design

Common Application

- Compact Track Loaders
- Agricultural Sprayers
- Road Construction: Pavers and Rollers
- Track or Wheel Drives

	CT05	CT07	CT11	CT17
Parking Brake	▲	▲	▲	▲
Soft Shift	▲	▲	▲	▲
2 Speed integrated axial hydraulic motor	▲	▲	▲	▲

▲ - Solution available

Specifications

		CT05	CT07	CT11	CT17
Max Intermittent Output Torque	in-lbs	45,800	56,645	97,350	159,138
	Nm	5,175	6,400	11,000	18,000
Max Continuous Output Torque	in-lbs	27,500	34,011	48,675	79,659
	Nm	3,107	3,843	5,500	9,000
Max Output Speed	rpm	163	163	137	76
Gear Ratios	(X:1)	21.67	21.67	21.14	35.83, 30.93
		24.00	-	25.79	43.00
		26.30	-	28.40	51.00
Max Working Pressure [delta]	PSI	5,583	5,800	5,800	5,800
	Bar	385	400	400	400
Max Motor Displacement	ccr	43.5	53.8	53.8	53.8, 49.1
Min Motor Displacement	ccr	17.3	23.4	23.4	23.4
		28.1	35.3	35.3	35.0, 30.0
Max Motor Speed (Min Displ.)	rpm	4,100	4,500	4,500	4,500
Motor Parking Brake Torque	in-lbs	2,742	3,540	3,540	3,540
	Nm	310	400	400	400
Unit Weight	lbs	194	209	235	290
	kg	88	95	107	131

Machine Classification

		CT05	CT07	CT11	CT17
Machine Power	Hp	60-74	74-100	100-130	>130
Machine Weight	lbs	8k-9.5k	9.5k-12k	12k-14k	14k-18k

For all machine power up to

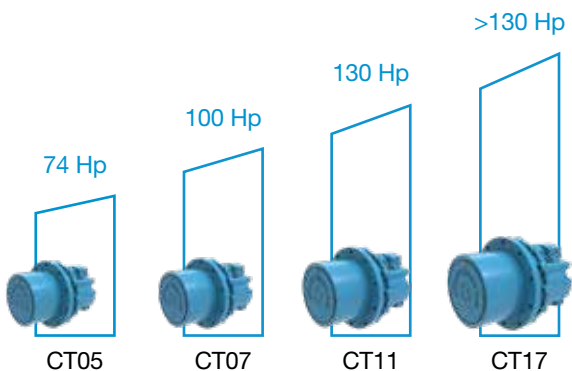

For all machine weights up to

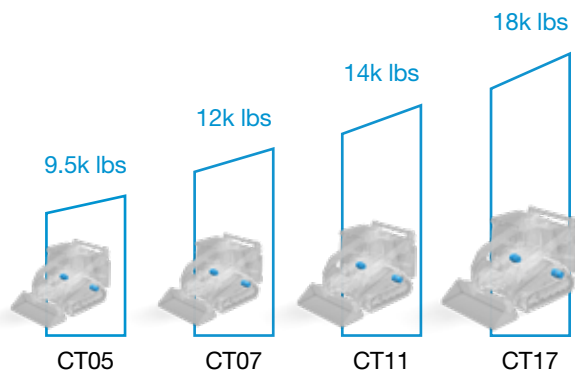

Dimensions

		CT05	CT07	CT11	CT17
A - Frame Outer Diameter	in [mm]	12.1 [310]	12.1 [310]	12.1 [310]	12.64 [321.1]
B - Frame Mounting Bolt Circle	in [mm]	11.024 [280]	11.024 [280]	11.024 [280]	11.496 [292]
C - Frame Pilot Diameter	in [mm]	10 [255]	10 [255]	10 [255]	10 [255]
D - Hub Outer Diameter	in [mm]	12.476 [316.88]	12.476 [316.88]	12.46 [316.5]	13.63 [346.2]
E - Sprocket Diameter Bolt Circle	in [mm]	11.22 [285]	11.22 [285]	11.22 [285]	12.402 [315]
F - Wheel Pilot Diameter	in [mm]	9.14 [232.15]	9.14 [232.15]	9.939 [249.91]	11.02 [279.91]
G - Spindle Flange to Center of Pressure Ports	in [mm]	4.241 [107.71]	5.09 [129.2]	5.09 [129.2]	5.09 [129.2]
H - Flange to Flange	in [mm]	2.957 [75.11]	2.957 [75.11]	2.957 [75.11]	2.957 [75.11]
I - Spindle Flange to Center of Case Drain Ports	in [mm]	2.343 [59.5]	2.58 [65.5]	2.58 [65.5]	2.58 [65.5]
J - Distance Between Pressure Ports	in [mm]	3.464 [88]	3.464 [88]	3.464 [88]	3.464 [88]
L - Overall Length	in [mm]	13.94 [354.1]	15.16 [385.2]	16.26 [413]	17.0 [431.8]
M - Pressure Port Size		1 1/16-12 UN	1 1/16-12 UN	1 1/16-12 UN	1 1/16-12 UN
N - Case Drain Port Size		3/4-16 UNF	3/4-16 UNF	3/4-16 UNF	3/4-16 UNF
P - Servo Pressure Port Size		9/16-18 UNF	9/16-18 UNF	9/16-18 UNF	9/16-18 UNF
R - Brake Port Size		9/16-18 UNF	9/16-18 UNF	9/16-18 UNF	9/16-18 UNF
T - Frame Mount Bolt Size (Holes)		M14x2 (12)	M14x2 (12)	M14x2 (12)	M16x2 (16)
U - Wheel Mount Bolt Size (Holes)		M16x2 (10)	M16x2 (10)	M16x2 (10)	M16x2 (14)

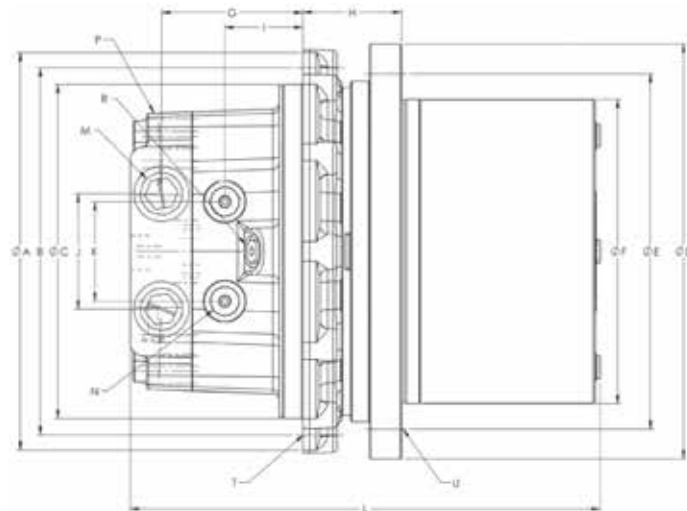

Dana.com/oh/contact

Application Policy

Capacity ratings, features, and specifications vary depending upon the model and type of service. Application approvals must be obtained from Dana; contact your representative for application approval. We reserve the right to change or modify our product specifications, configurations, or dimensions at any time without notice.



SPICER[®]

Torque-Hub[™]