

# Spicer® D172 Series Heavy-Duty Tandem Axle

Delivering efficiency, reliability, weight savings, and strength to construction, heavy haul, and severe service applications

D40-172

D46-172

D50-172



**SPICER®**

*Drivetrain Products*

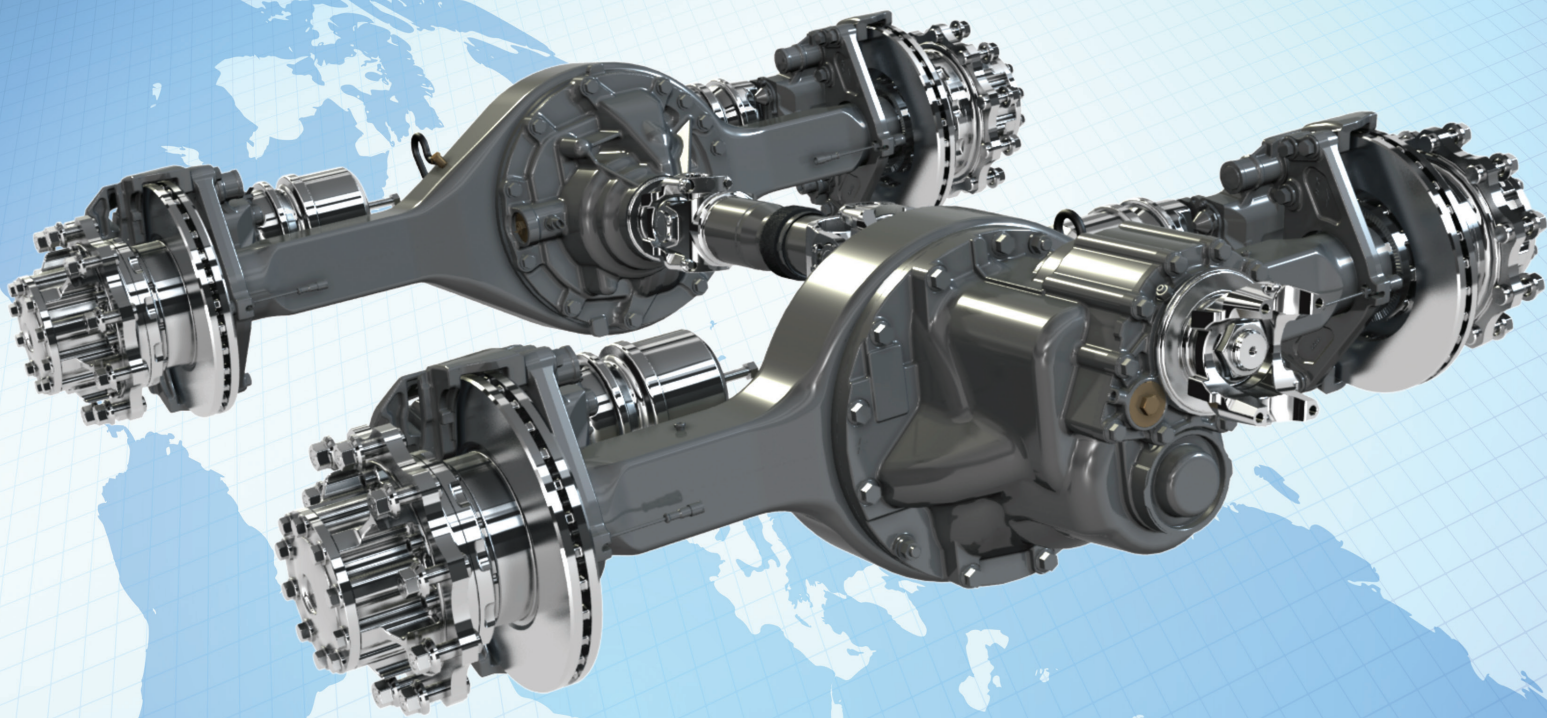

## **Lightweight, durable, reliable, and efficient heavy-duty tandem.**

Over 60 pounds (27.2 kg) lighter than its predecessor, this new tandem axle is lightweight without compromising performance and durability. It combines design and product efficiency with application-specific demands to maximize fleet uptime.

# Spicer® D172 Series Heavy-Duty Tandem Axle

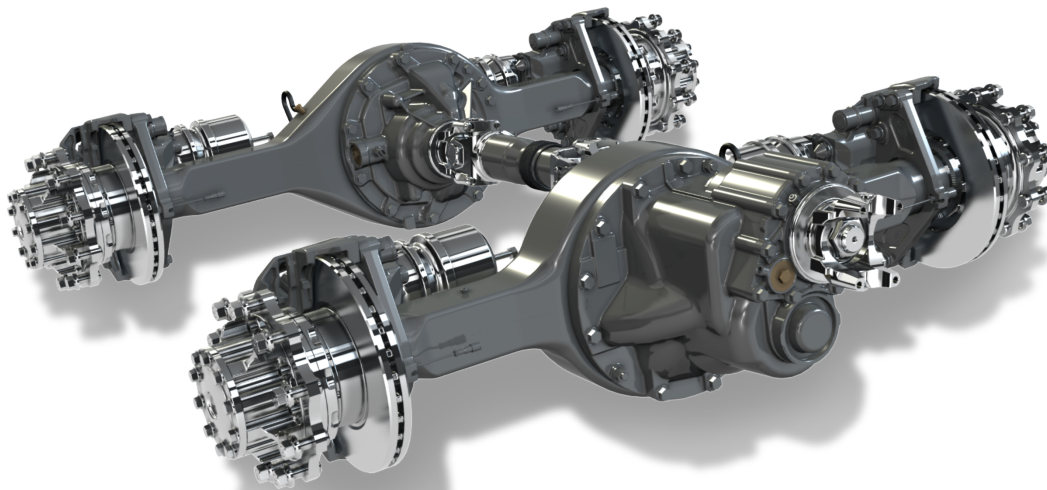

## Lightweight without compromising strength

Today, customers are looking for lighter weight tandem drive axles that provide reliability, strength, and efficiency. They'll find it here.

### Product benefits include:

- Broad range of ratios, 3.07 to 6.14, supporting a variety of vocations
- Wide-face, High-Power Density™ AdvanTEK® gearing maximizes strength while reducing weight
- Patented flow-through lubrication system in power divider unit
- Large inter-axle differential
- FE and XFE lube can be specified to further boost fuel economy

### Optional Features:

- Heavy-duty wall designs for severe-service applications
- Integrated, driver-controlled wheel differential lock for maximum traction and spin-out protection
- Patented, on-demand lube pump
- SelectTrac™ option enables use of dual or single-wide-based tires
- Wide track options available

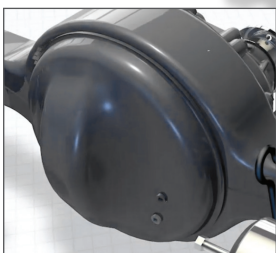

## LIGHTWEIGHT

With over 60 pounds of weight savings, this new tandem axle is lightweight without compromising performance and durability.

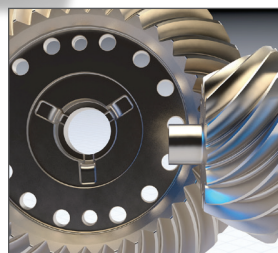

## REDUCED MAINTENANCE COSTS

A reliable, passive lube management system requires less lube while utilizing a patented lube meter to optimize the amount of lube flow to the high-efficiency bearings.

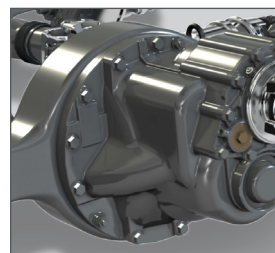

## ENHANCED RELIABILITY

One-piece carrier design with patented power rib on both front and rear axles.

### Tandem Axle Specifications

Axle Model	Ratings		Ratios	Axle Shaft			Nominal Ring Gear Diameter in. [mm]	Axle Housing			Spindle Type	Options					
	Max. GAW lbs. [kg]	Max. GCW HWY lbs. [kg]		Body Diameter in. [mm]	Number of Splines	Spline Diameter in. [mm]		Box Section Width in. [mm]	Box Section Height in. [mm]	Wall thickness at spring seat in. [mm]		LMS™ Hub	Central Tire Inflation System (CTIS)	Differential Lock	Pump	Electron-geometric Rearbair	No Spin Differential
D40-172	40,000 [18,144]	160,000 [72,575]	3.07, 3.21, 3.42, 3.58, 3.73, 3.91, 4.10, 4.30, 4.56, 4.78, 5.25, 5.38, 5.57, 6.14	2.06 [52]	46	2.35 [60]	F 17.7 [440] R 17.3 [440]	4.61 [117]	5.24 [134]	0.43 [11]	R						
D46-172	46,000 [20,865]									0.50 [12.5]							
D50-172	50,000 [22,680]									0.63 [16]							

To learn more about the unique applications of Dana's latest tandem axle innovation, visit [dana.com/cv](http://dana.com/cv)

Dana Commercial Vehicle Driveline Technologies

3939 Technology Drive  
Maumee, Ohio, USA 43537  
[dana.com](http://dana.com)



**SPICER®**

Drivetrain Products

### Application Policy

Capacity ratings, features, and specifications vary depending upon the model and type of service. Application approvals must be obtained from Dana; contact your representative for application approval. We reserve the right to change or modify our product specifications, configurations, or dimensions at any time without notice.